

SUSPENDED CEILING BOARD



Suspended Ceiling Boards are made of glass wool boards faced with decorative glass tissue or PVC on one side. They are used for space acoustics, thermal insulation of under the floors and roofs, for aesthetical purposes to conceal HVAC installations and ducts from view or they are just used for decorative purposes.

Application

The fact that suspended ceiling boards are lightweight makes the application easier to proceed. It is recommended to prepare a ceiling tile plan before the application. Since the width of the board is 60 cm, the width of the application area is divided into multiples of 60. Taking the longitudinal axis of symmetry as the beginning offers a better aesthetic solution. Afterwards, the same process is carried out for the other axis for the board length of 120 cm or for a square of 60 x 60 cm. when the board is divided into two. Type and quantity of the lighting fixtures should be determined by the needs and should be designed and shown on the ceiling tile plan.



Name	Facing	Thickness (cm)	Width x Length (cm)	Package (m ²)
Labyrinth	pvc	2	60x60-120	7,2
Crater	pvc	2	60x60-120	7,2
Random	pvc	2	60x60-120	7,2
Travertine	pvc	2	60x60-120	7,2
Matting	pvc	2	60x60-120	7,2
White	glass tissue	2	60x60-120	7,2
Labyrinth	pvc	2,5	60x60-120	5,76
Crater	pvc	2,5	60x60-120	5,76
Random	pvc	2,5	60x60-120	5,76
Travertine	pvc	2,5	60x60-120	5,76
Matting	pvc	2,5	60x60-120	5,76
White	glass tissue	2,5	60x60-120	5,76

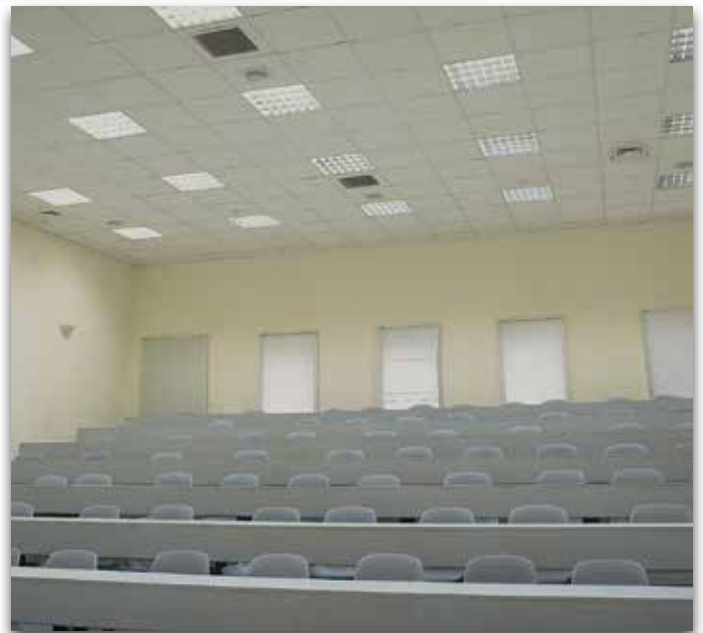

- High thermal insulation
- Acoustic control
- Easy to apply
- Lightweight



TECHNICAL DATA SHEET

Izocam Suspended Ceiling Board

Properties	Symbol	Unit	Description	Tolerance	Standard	
Material	-	-	Glass Wool	-	TS EN 13964	
Density	ρ	kg/m ³	50	+/-10%	-	
Width	w	mm	600	+/-1,5%	TS EN 822	
Length	l	mm	1200	+/-2%	TS EN 822	
Thickness	t	mm	20	25	-1, +5	TS EN 823
Facing	-	-	Glass Tissue	PVC	-	-
Reaction to fire	-	-	NPD		-	TS EN 13501-1
Declared Thermal Conductivity (10 °C)	λ_D	W/m.K	0,031		-	TS EN 12667/12939
Thermal Resistance	R_D	m ² .K/W	0,60	0,80	-	-
Sound Absorption	-	α_w	0,4	0,5	-	TS EN ISO 354
Specific Heat *	c	kJ/(kg.K)	0,84		-	EN 12524
Dynamic Elasticity *	Edyn	kN/m ²	0,8		-	DIN 52214
Packaging Material	-	-	Carton Box		-	-

* Literature value.

Safety Reminders for Loading, Unloading, Shipping and Storing

- These operations should be done indoors in case of rainy weather conditions.
- Loading and unloading should be done by (at least) two people.
- Products should be wrapped by a waterproof cover even if the shipping distance is short.
- Products should not be superposed with pallets.
- Products should not be put into upright position.
- Products should not be stepped on and should not be used as steps.
- Products should not be pulled by their package.
- Before binding, hard cardboards (minimum 20 x 50 cm) should be put on the corners of packages to protect against possible damages by ropes.
- Storage area should be protected against any wet threats such as rain, float, etc. Indoor spaces should be preferred.
- The packages should be put on the floor with extra care so the corners of the product especially is not damaged by a hit.
- The instructions on the packages should be followed.

Izocam is not responsible for any problem because of misprinting. Izocam, the manufacturer, reserves the right to alter product specifications without prior notice. Izocam also manufactures special products upon request. For your requirements, you are requested to contact our Export Department.

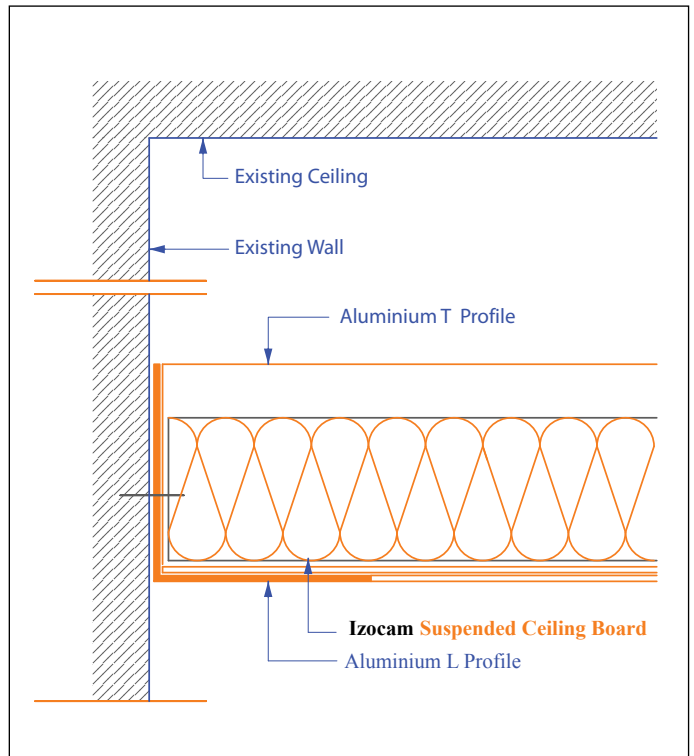

ENCYATL2015/06